

### 5085 CATCH BASIN INLET

Heavy duty  
 ADA grate  
 Approximate 84 sq. in. open area

Options  
 Bolted assembly  
 Ductile iron



Illustrating Type M2 bolted ADA grate



**Type M1 Bolted Grate**  
 Medium duty  
 Approx. 143 sq. in. open area

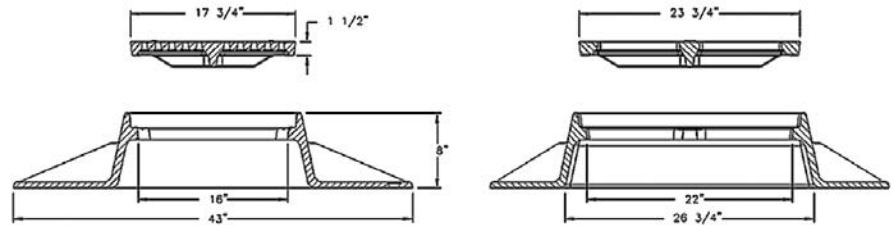

### 5100 CATCH BASIN INLET

Heavy duty  
 Concave inlet with 5105 Type M1 grate  
 Approximate 175 sq. in. open area  
 Accepts 5105 grates

Options  
 4" height stackable frames  
 ADA grate — 5105M3

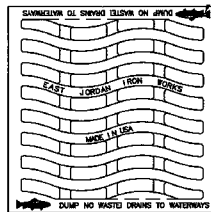
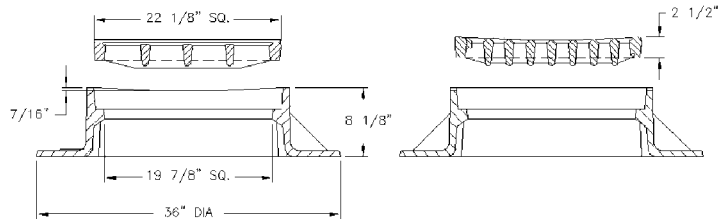

**Type M1 5105 Grate**  
 "DUMP NO WASTE!"  
 Lettering and fish image



**Type M2 5105 Sinusoidal Grate**  
 Approx. 210 sq. in. open area  
 Does not have cross bars, for expressway use only.



**Type M3 5105 ADA Grate**  
 "DUMP NO WASTE!"  
 Lettering and fish image

Supplied By:



877-903-7246  
 www.trenchdrainsupply.com

